

\$450,000 - 191014 Township Road 685, Rural Athabasca County

MLS® #A2129454

\$450,000

0 Bedroom, 0.00 Bathroom,
Land on 155.34 Acres

NONE, Rural Athabasca County, Alberta

Here's a quarter section that offers a solution to just about any thing can suggest. Located east of the AIPac Mill in Athabasca County. It has some open land for income generation. It has some low treed land for recreation. It has a house that was moved onto a basement that was never finished. It had a camp and therefore services were in. It has a five acres graveled pad for a camp or laydown yard. It has pavement to the driveway so road bans never affect it. It will take the right person to need or utilize all that this quarter offers. Possibilities are endless.

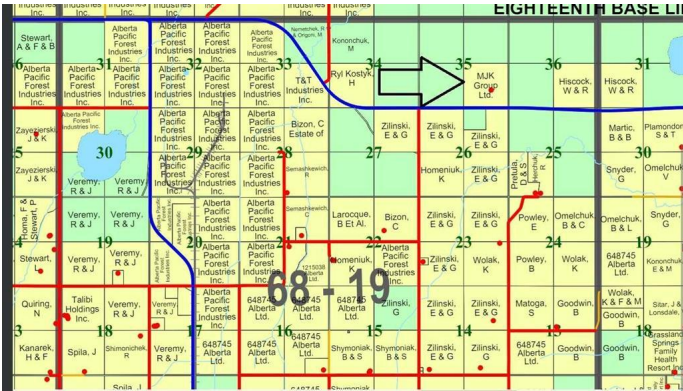

Essential Information

MLS® #	A2129454
Price	\$450,000
Bathrooms	0.00
Acres	155.34
Type	Land
Sub-Type	Residential Land
Status	Active

Community Information

Address	191014 Township Road 685
Subdivision	NONE
City	Rural Athabasca County
County	Athabasca County

Province	Alberta
Postal Code	T0A 1Z0

Additional Information

Date Listed	May 6th, 2024
Days on Market	354
Zoning	Ag

Listing Details

Listing Office	ROYAL LEPAGE COUNTY REALTY
----------------	----------------------------

Data is supplied by Pillar 9â„¢ MLS® System. Pillar 9â„¢ is the owner of the copyright in its MLS® System. Data is deemed reliable but is not guaranteed accurate by Pillar 9â„¢. The trademarks MLS®, Multiple Listing Service® and the associated logos are owned by The Canadian Real Estate Association (CREA) and identify the quality of services provided by real estate professionals who are members of CREA. Used under license.